



WARNING!

(MUST READ PRIOR TO INSTALLATION)

I. Water Ingestion Disclaimer:

This product is intended for general highway use only! Under normal driving conditions water ingestion is usually not an issue; however, if the product becomes submerged from rain splashes or mud puddles due to harsh rains or flooding the engine may ingest water which could cause severe engine damage. Do NOT use this product when crossing any body of water including but not limited to large puddles, streams, rivers or lakes. **S&B has conducted extensive water testing with Southwest Laboratories to design a product, which was engineered to protect your vehicle. The testing was done at 700 CFM and according to the SAE J2554, Engine intake Air Water Separation Test Procedure that has been attached and can also be found on our website.**

If your engine ingests water, this could cause severe engine damage by hydro-lock or other conditions. Care should be taken to avoid these driving conditions. **ENGINE DAMAGE CAUSED BY THE INGESTION OF WATER INTO THE ENGINE IS THE DRIVER'S RESPONSIBILITY AND IS NOT COVERED BY S&B FILTERS!**

The table below demonstrates what percentage of the water bypassed the filter during the SAE J2554 Test Procedure.

Standard Scoop Configuration With:	Water Bypassing the Filter, %
Cotton Filter (KF-1053)	0.00

Visit www.sbfilters.com to see the entire Test Report and learn more about this product.

II. Scoop Obstruction:

Regularly inspect the entire Scoop Inlet for any obstruction or debris that may impede the flow of air.

III. Decreased Ride Height

Once the Scoop has been installed, please be aware that the Scoop sits lower than the bumper and drive accordingly to avoid damage to the scoop or vehicle. Make sure there is plenty space between your tire and the scoop before driving. The scoop system may not work with aftermarket wheels and tires.

Ride height with this scoop installed is decreased by 2.0" on the passenger side.

IV. Do NOT Seal Off Stock Inlet Location:

In addition to pulling air from the base of the air box, the S&B Cold Air Intake Kit pulls air from the same location as the stock induction system. **UNDER NO CIRCUMSTANCE SHOULD YOU SEAL OFF THIS AIR INLET.** Doing so could result in severe injury or death or damage to the vehicle or property. Sealing off the stock air inlet could cause a significant vacuum should the Scoop become partially or completely obstructed which among other things could pull oil into intake tube leading to an explosion and/or a run-away truck condition as the oil would serve as fuel to the engine.

V. Warranty for Scoop & Filter Wrap

S&B provides a limited warranty to guarantee the product is free of material and workmanship defects. Any product will be replaced upon identification of such defect. Normal wear and tear is not covered under this warranty. Final authorization is at the sole discretion of S&B Filters, Inc.

VI. How long will the Scoop & Filter Wraps Repel Water?

The Scoop & Filter Wraps are specially treated to repel water. The water repellency longevity is dependent upon driving conditions and the number of times the filter is cleaned. Generally speaking, we recommend changing the Filter Wrap every 6-12 months. However, a quick test can determine if it is time to change your Filter Wrap. Simply take an ordinary clean spray bottle filled with water and gently spray the Filter Wrap. If the water beads off the Filter Wrap, your water repellency is still working. If you see water enter through the Filter Wrap, it is time to purchase a new Filter Wrap.



INSTALLATION INSTRUCTIONS

Important: Read warning page prior to proceeding.

VEHICLE APPLICATION

Year: 2010-12
 Make: DODGE
 Model: RAM 2500/ 3500
 Engine: 6.7L DIESEL
 (Factory bumper only)

STANDARD FACTORY BUMPER ONLY



TOOLS REQUIRED

- 8mm Socket
- 18mm Wrench or Deep Socket
- 7/16" & 1/2" Wrench & Socket
- 5/16" Nut Driver or Flat Blade Screwdriver

NOTES

Kit may not fit with the following:

- Aftermarket Bumper
- Body Lift or Lowering Kit
- Front Hitch
- Oversized Wheels and Tires

BEFORE YOU START

- Please read the entire product guide before proceeding.
- Ensure all components listed on page 4 are present.
- If you are missing any of the components, call our customer support at (909) 947-0015.
- Do not attempt to work on your vehicle while engine is hot.
- Make sure the engine is turned off and the vehicle is in Park or the Parking Brake is set.

1. With the ignition switched off and the parking brake set, disconnect the negative battery cables on both batteries.



2. Disconnect the IAT sensor wiring harnesses from the sensor.



3. Loosen both the #72 Hose Clamps on the Hump adapter, then slide the hump adapter over the Filter adapter tube.

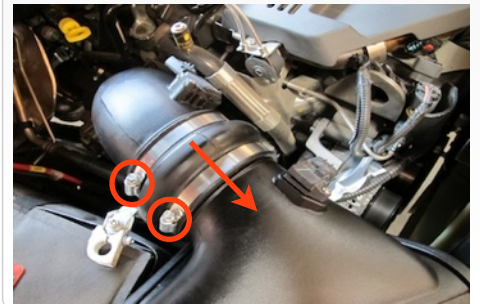

4. Remove the M8x1.25x40mm Allen Head screw from the air box and remove the complete air box assembly from the truck.



5. If installed, remove the S&B Box plug from the lower portion of the air box using 7/16" socket. Retain plug and all hardware if you expect on driving through heavy rain or snow.

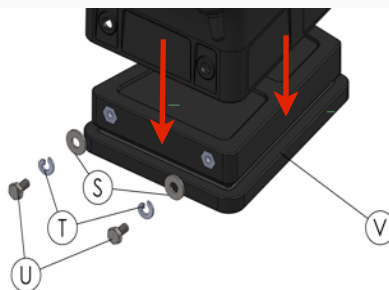

6. Apply a small amount of the supplied Blue Loctite to all (6) 1/4"-20 Hex Bolts (B).



7. Slide the Speed Clip Nuts (C) over the flange of the Scoop Channel (D). Make sure the nuts clip into place.



8. Secure the Channel assembly to the air box using the supplied 1/4"-20 Screws (B), 1/4" Split Lock washers (K), and 1/4" Flat Washers (A).



9. Slide the air box/ channel assembly down from the engine compartment and set the air box back into the two factory grommets on the side of the battery tray.



SEE EXPLODED VIEW ON PAGE 5



INSTALLATION INSTRUCTIONS (continued)

10. Reinstall the Socket pan head screw removed in Step #4.



11. Install the four supplied Speed Clip Nuts (C) over the flange of the Scoop Base (E). Make sure the outside tabs snap into the holes.



12. Install the Mounting bracket (H) to the top of the Scoop Base (E) using two 5/16"-18 Hex Bolts (G), two 5/16" Hex Nuts (H), and four Flat Washers (F). Leave hand tight for now.

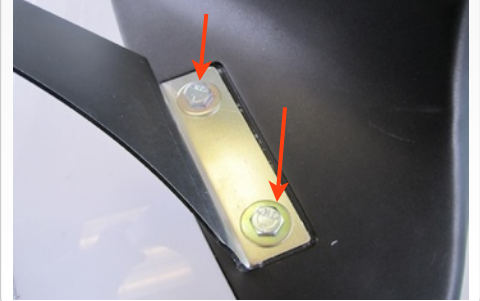

13. From under the truck using 18mm socket, remove the nut behind the bumper.



14. Slide the Scoop base assembly up into the Scoop Channel (D) and slide the mounting bracket (H) over the stud behind the bumper.



15. On the backside of the assembly, secure the Scoop Base to the Channel using the two 1/4"-20 Screws (B), 1/4" Split Lock washers (K), and 1/4" Flat Washers (A).



16. On the frontside of the assembly, secure the Scoop Base to the Channel using the two 1/4"-20 Screws (B), 1/4" Split Lock washers (K), and 1/4" Flat Washers (A).



17. When you are satisfied with the positioning, tighten down the Mounting bracket (H) to the Scoop Base (E) using two 1/2" wrenches (one on top and one inside).



18. Reinstall the nut behind the front bumper securing the Mounting bracket (H). Torque to factory specs.



19. Check to make sure the Scoop assembly does not interfere with the wheel or wheel well liner. Turn the wheel in both directions while trying to simulate full suspension travel.



20. Inspect the entire installation, be sure the kit is properly positioned and all fasteners are secure.



21. Reinstall IAT sensor connection and hump adapter. Tighten both #72 hose clamps. Reconnect both batteries terminals. The installation is now complete.

See warnings on Page #1.



SEE EXPLODED VIEW ON PAGE 5



Scoop Plug Installation

When to use the plug.

We recommend installing the plug during the winter months if you in an area that receives snow or excessive rain.

1. From under the truck using 18mm socket, remove the nut behind the bumper. Slide the mounting bracket off the stud. Then re-attach the nut and torque to factory specs.



2. On the backside of the assembly, remove the two 1/4"-20x1.0" Screws (B), 1/4" Split Lock washers (K), and 1/4" Flat Washers (A) mounting Scoop base to the channel.



3. On the frontside of the assembly, remove the two 1/4"-20x1.0" Screws (B), 1/4" Split Lock washers (K), and 1/4" Flat Washers (A).

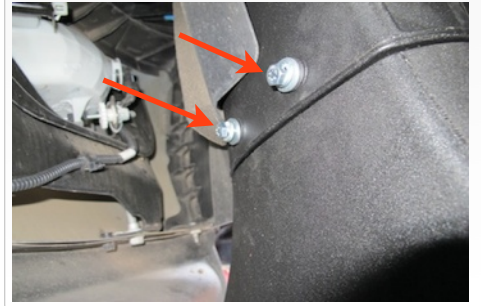

4. Install the Plug (L) into the Scoop Channel using the two 1/4"-20x3/4" Screws (M), 1/4" Split Lock washers (K), and 1/4" Flat Washers (A).



SEE EXPLODED VIEW ON PAGE 5



EXPLODED VIEW

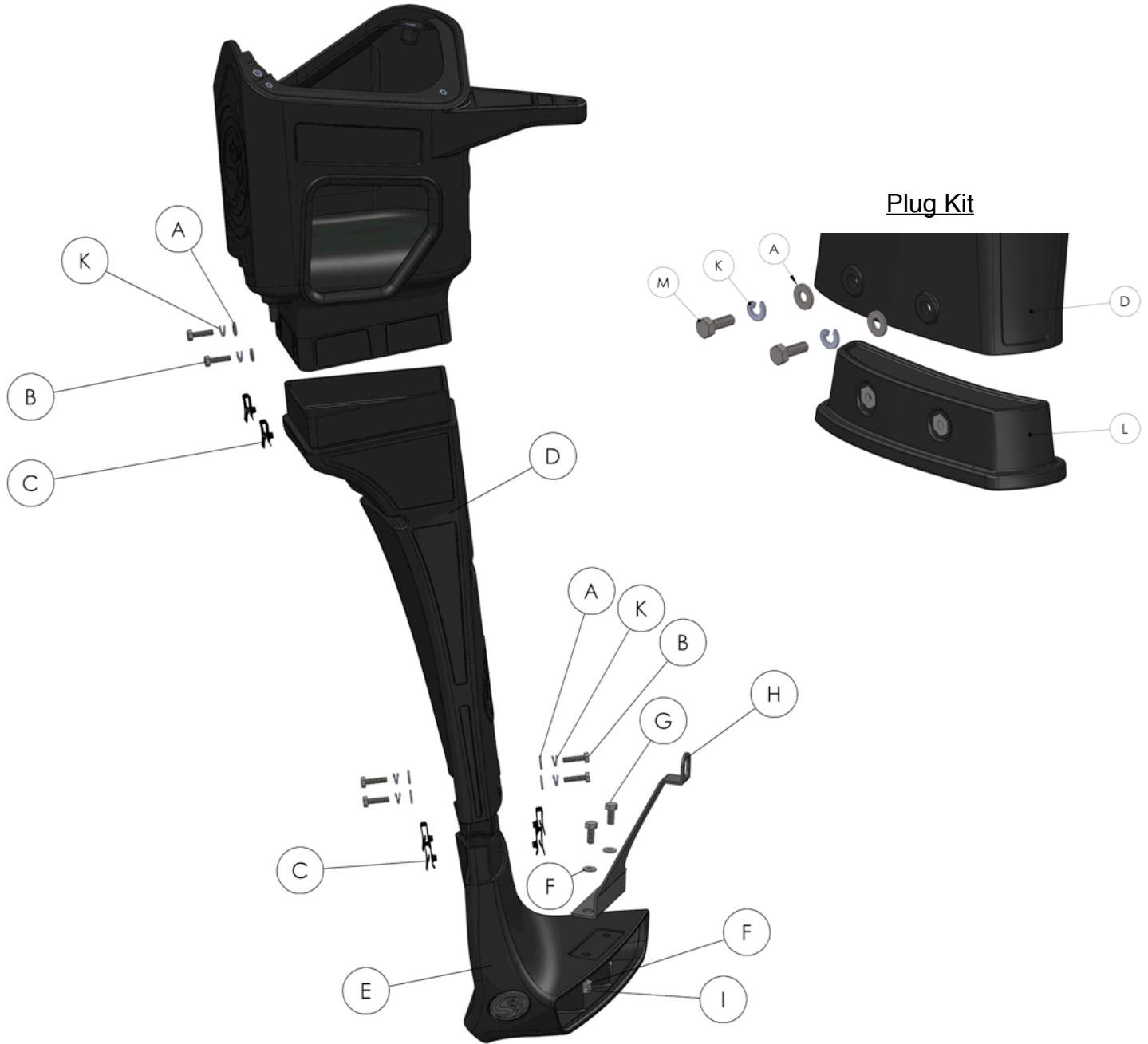

ITEM	QTY.	DESCRIPTION	P/N
A	8	Washer, 1/4"ID x 5/16"OD	AI1073-00
B	6	Hex Head Screw, 1/4"-20x1.0"	AI1131-00
C	6	Speed Clip Nut, 1/4-20	AI1059-00
D	1	Scoop, Main Channel	AL1164-00
E	1	Scoop, Base	AL1165-00
F	4	Washer, Flat USS, 5/16"ID	AI1093-00
G	2	Hex Head Screw, 5/16"-18x3/4"	AI1467-00
H	1	Lower Mounting Bracket	AI1543-00
I	2	Nut, Hex Nylock, 5/16"-18	AI1298-00
J	1	Loctite 242, .02oz., Blue	AI1406-00
K	8	Washer, Split Lock, 1/4"	AI1309-00
L	1	Scoop, Plug	AL1166-00
M	2	Hex Head Screw, 1/4"-20x3/4"	AI1068-00
N			

AM0177-00 Rev.B 04/29/13

PERFORMANCE TESTING

- Engage parking brake and start your engine. Listen for abnormal noises. If an air leak is detected, re-inspect hoses and connections as they may need to be repositioned and tightened.
- S&B FILTERS recommends that you keep your OE intake system in the event it is required in the future.
- In order to maintain your warranty, all connections and components must be checked periodically for alignment and for proper tension on all connections. Failure to do so may void your warranty.
- Use only S&B FILTERS cleaning and oil products to service your filter. Using any other brand oil and or cleaners on your S&B air filter may void your warranty.

RELATED ITEMS FOR YOUR PURCHASE

- Air Filter Wrap (S&B P/N: WF-1032)