



## INSTALLATION INSTRUCTIONS

### Vehicle Application

Year: **2003-2007.5**  
 Make: **DODGE**  
 Model: **RAM 2500/ 3500**  
 Engine: **5.9L TURBO DIESEL**

### Tools Required

- 10mm Wrench & Socket
- 1/2" Wrench & Socket
- 7/16" Wrench & Socket
- 5/16" Nut Driver or Flat Blade Screwdriver
- Phillips Screwdriver, Pliers or Channel locks

### S&B Filter Maintenance

Cleanable (KF-1035). If the enclosed filter is Red, it came pre-oiled from the factory. Please visit [www.sbfilters.com](http://www.sbfilters.com) for the exact oil amount required after cleaning.

Disposable (KF-1035D). If the enclosed filter is White, it is a disposable filter and should be discarded once it reaches capacity. This filter (does not require oil). For more info on S&B's disposable filter, visit [www.sbfilters.com](http://www.sbfilters.com).

### Notes

Kit may not fit with the following:

- Aftermarket Parts installed
- Body Lift or Lowering Kit
- Custom Hood
- Intercooler or Turbo upgrades

### Before You Start

- Please read the entire product guide before proceeding.
- Ensure all components listed on page 4 are present.
- If you are missing any of the components, call our customer support at (909) 947-0015.
- Do not attempt to work on your vehicle while engine is hot.
- Make sure the engine is turned off and the vehicle is in Park or the Parking Brake is set.

1. With the ignition switched off and the parking brake set, disconnect the negative battery cables on both batteries.



2. Disconnect the electrical connection for the Intake Air Temp. (IAT) Sensor, then unclip the wire loom from the tube.



3. Loosen the hose clamp at air box lid and unsnap the clamps to remove the air box lid and stock air filter.

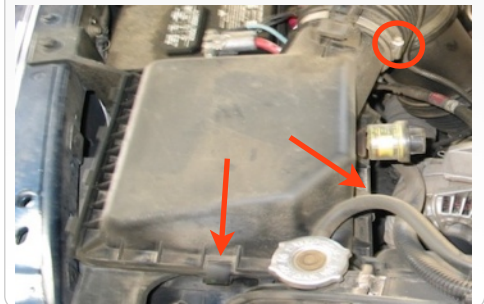

4. Remove the mounting nut then pull up and out on the lower half of the stock air box to remove it from the vehicle.



5. Loosen the hose clamp at the turbo inlet and remove the stock intake tube.



6. Remove the IAT sensor from the stock air box/ lid, use the supplied 8-32 Screws (E) and IAT Gasket (D) to secure the sensor to the S&B Intake Tube (C).



7. Place the Silicone adapter (B) and both #64 Hose Clamps (A) onto the Intake tube (C) as shown. Tighten the clamp on the intake tube so that the screw can be accessed for future tightness checks.



8. Install the S&B Air Filter (O) to the Filter Adapter (I) and secure the #80 Hose Clamp (H). Position so the flat side of the oval pointing upward parallel to the edge of the adapter.



9. Slide the 2 #72 Hose clamps (F) over the Hump Adapter (G). Then push the Hump adapter (G) over the Adapter tube (I). Leave clamps loose for now.



**SEE EXPLODED VIEW ON PAGE 4**



**INSTALLATION INSTRUCTIONS (continued)**

10. For those concerned about minimal engine heat; install the Box Plug (Q) onto the bottom of the Air Box (P) using the 1/4-20 hardware. For those seeking additional air flow, set the Box Plug aside.

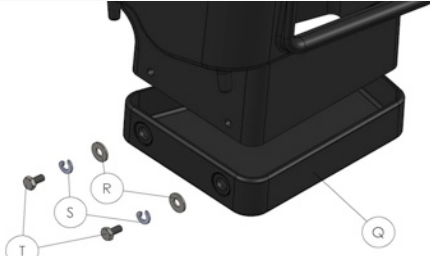

(See page 3 for more info)

11. Install the Air Box (P) by pushing the prongs on the bottom into the OE grommets. Then using the stock nut removed in Step #4.



12. Carefully place the filter assembly into the Air Box trying not to ding or gouge the wire mesh. Rotate the Filter Adapter assembly into position and hook into the groove Air Box.



13. Install the Intake tube assembly by pushing the silicone adapter over the turbo inlet. Leave loose for now.



14. Slide the Hump Adapter (G) over the Intake tube (C).

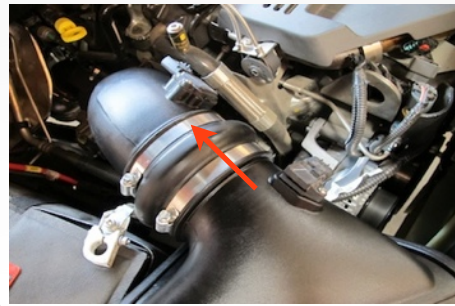

15. Make sure the Intake tube (C) and Adapter tube (I) are aligned up top and tighten the hose clamp at the turbo connection. Then tighten the #72 Clamps (F) on the Hump Adapter.



16. Reconnect the IAT Sensor.



17. Install the Clear Lid (N) using the supplied 5/16" S.S. Screws (K) and Rubber Washers (J) along with the 10-24 Screws (L) and SS Sealing Washers (M). This will secure the Filter Adapter to the Air Box as well.



18. Reconnect both batteries. Inspect your installation, make sure the kit is properly positioned and all fasteners are secure. Affix the CARB sticker near the intake kit. The installation is now complete.



**RELATED ITEMS FOR YOUR PURCHASE**

- Air Scoop Assembly (S&B P/N: AS-5049)
- Air Filter Wrap (S&B P/N: WF-1023)
- Water Protection Scoop Wrap (S&B P/N: WF-1028)
- Snow Scoop Plug and Mounting Bracket kit (S&B P/N: 75-5051)

**SEE EXPLODED VIEW ON PAGE 4**



## INSTALLATION INSTRUCTIONS

### Precision II Filter Cleaning & Oiling



Order online today at [www.sbfilters.com](http://www.sbfilters.com) or  
through your local S&B distributor.  
Part #: 88-0008

### PERFORMANCE TESTING

- Engage parking brake and start your engine. Listen for abnormal noises. If an air leak is detected, re-inspect hoses and connections as they may need to be repositioned and tightened.
- S&B FILTERS recommends that you keep your OE intake system in the event it is required in the future.
- In order to maintain your warranty, all connections and components must be checked periodically for alignment and for proper tension on all connections. Failure to do so may void your warranty.
- Use only S&B FILTERS cleaning and oil products to service your filter. Using any other brand oil and/or cleaners on your S&B air filter may void your warranty.

### Air Box End Cap Testing

Stock air boxes are a significant contributor to poor air flow which is why S&B designs custom air boxes with secondary and/or enlarged openings. With that said, S&B recognizes the benefits of cooler air, so we have included a plug to seal off the opening if so desired. For optimal performance, we recommend that the intake be used without the end cap except in conditions of extreme heat. Without the plug installed on the box, there is an additional improvement in airflow.

Visit the product page for this intake at [www.sbfilters.com](http://www.sbfilters.com) to see the actual test results outlined in detail.

### Emissions Standard

The California Air Resource Board (CARB) requires that an E.O. identification label be applied to the vehicle in order to pass a smog check inspection when a Performance Intake Kit has been installed. You must place the E.O. label provided on or near the intake kit after installation so that a smog check technician can easily verify the E.O. number. As of April 2009, S&B has never had a product where CARB denied an exemption request; however, the exemption process with CARB can take as long as 18 months. Check the status of the exemption process by looking up a specific part number at [www.sbfilters.com](http://www.sbfilters.com). The CARB Exemption number and/or status is listed under the Product Details section for each part number. If the status shows as "Pending," CARB has yet to issue an exemption. Products that have not been issued an EO number are street legal in most states, but may not be used on emission controlled vehicles in the state of California and are for off road use only. If you purchased your kit from S&B Filters directly, we will automatically mail you your Exemption Sticker when it is issued to us. If you purchased your kit from an authorized S&B Filters Dealer, log onto our web site and register to receive your Exemption Sticker.

**SEE EXPLODED VIEW ON PAGE 4**



**EXPLODED VIEW**

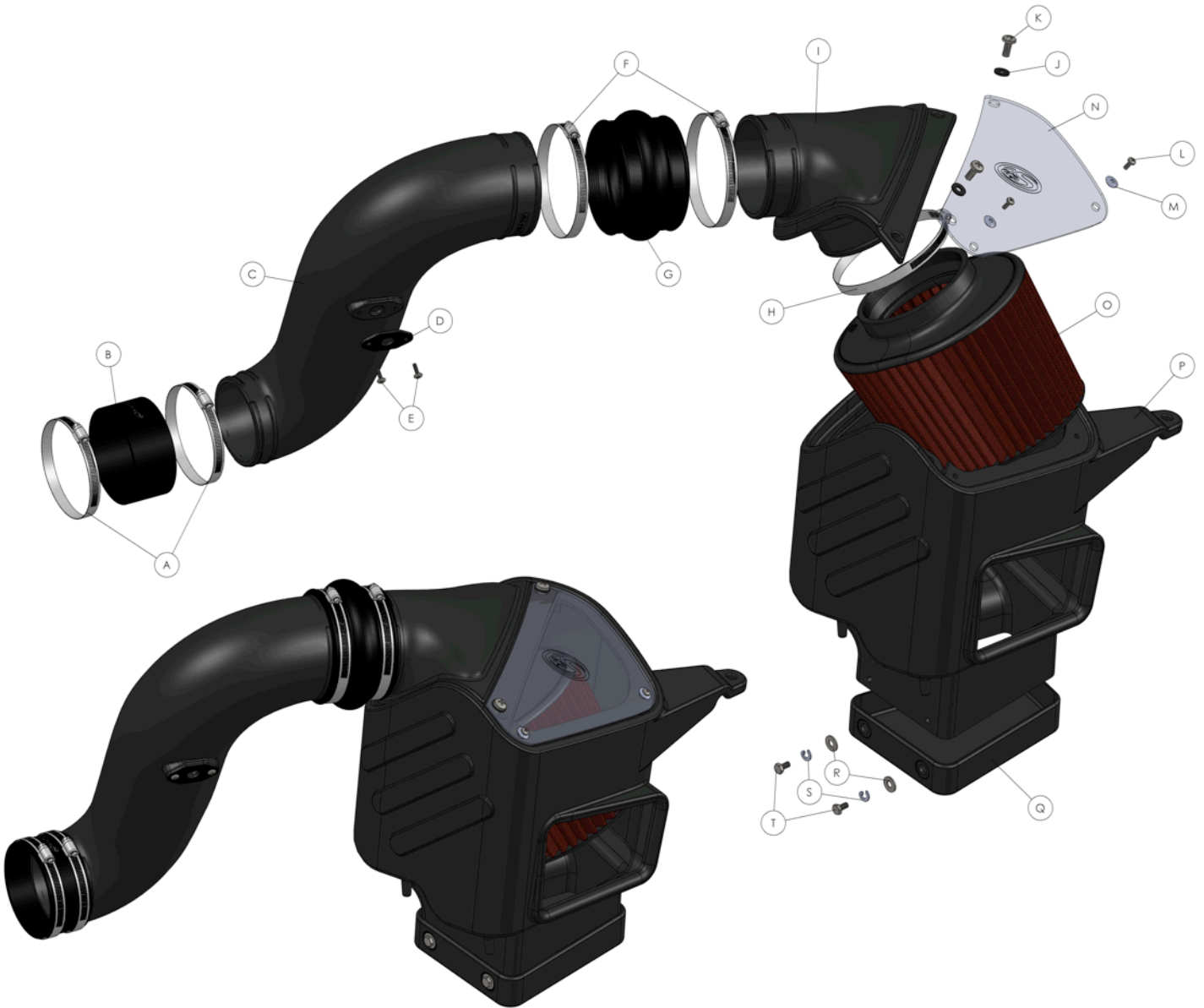

ITEM	QTY.	DESCRIPTION	P/N
A	2	Hose Clamp, #64	AG1018-00
B	1	Silicone Adapter, 4.10" x 2.0"	AI1029S-00
C	1	Intake Tube	AL1206-00
D	1	IAT Sensor Gasket	AI1344-00
E	2	S.S. Screw, 8-32 x 5/8"	AI1434-00
F	2	Hose Clamp, #72	AG1009-00
G	1	Hump Adapter, 4.50" x 3.0"	AI1462C-00
H	1	Hose Clamp, #80	AG1010-00
I	1	Filter Adapter Tube	AL1206A-00
J	2	Rubber Washer	AI1435-00
K	2	S.S. Screw, 5/16-18 x 1.0"	AI1297-00
L	2	S.S. Screw, 10-24 x 1/2"	AI1287-00
M	2	S.S. Sealing Washer, 10-24	AI1272-00
N	1	Clear Box Lid	AI1442-00

ITEM	QTY.	DESCRIPTION	P/N
O	1	S&B Air Filter	KF-1035
P	1	S&B Air Box	AL1107-00
Q	1	Box Plug	AL1207-00
R	2	Washer, Flat, 1/4"	AI1073-00
S	2	Washer, Lock, 1/4"	AI1309-00
T	2	Hex Bolt, 1/4-20 x 3/4"	AI1068-00

**Warranty**  
Visit [www.sbfilters.com](http://www.sbfilters.com) for complete warranty information.